

SECTION: A-A

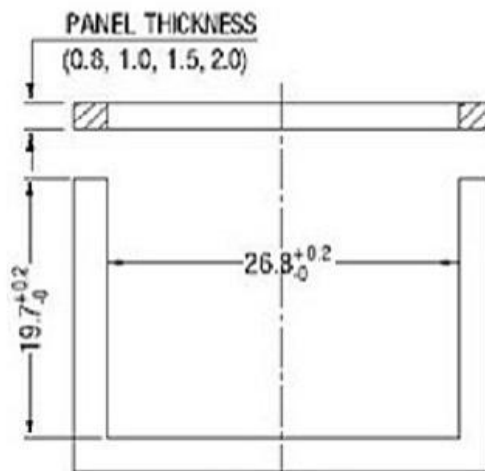

PANEL CUT-OUT

**SPEC:**

**A. Material:**  
 1. Housing: PBT  
 2. Terminal: COPPER ALLOY, TIN PLATED

**B. Electrical Characteristics:**  
 1. Rating: 15A 250V~ (UL,CUL)  
 10A 250V~ (CCC,VDE,SEMKO,NEMKO,FIMKO,DEMKO,KC)  
 2. Electric Strength: AC 2,000 V FOR ONE MINUTE  
 3. Insulation Resistance: 100MΩ MIN. AT 500V DC

**C. Approvals:**  
 UL, CUL, CCC, VDE, SEMKO, NEMKO, FIMKO, DEMKO, KC

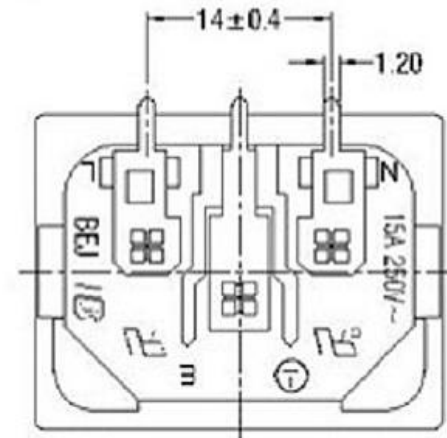

PART NO.:	DIM. X
ST-A01-003JT-33(0)	0
ST-A01-003JT-33(0.8)	0.8
ST-A01-003JT-33(1.0)	1.0
ST-A01-003JT-33(1.5)	1.5
ST-A01-003JT-33(2.0)	2.0

				普通公差 COMMON TOLERANCE:	 <b>东莞市高迪电子有限公司</b>					
				UP TO 5      ±0.20					单位 UNIT	mm
				ABOVE 5 TO 30      ±0.30	绘图 DRAWN BY	林晓良	核对 CHECKED BY	型号 MODEL NO.		
REV.	DATE	REVISION DESCRIPTION	ISSUE	ABOVE 30      ±0.50	日期 DATE	19.08.12	核准 APPROVAL BY	料号 PART NO.	KD-AC电源插座	
				ANGULAR      ±5°						